



INSTALLATION INSTRUCTIONS

GTI EL5 CONNECT

These instructions are specifically written for the installation of the following products:

Product	Size	Thickness	Installation direction	Seams Welded
GTI Connect ESD	25" x 25"	6 mm	Same	CR 50 where needed
Conductive welding Rod	4 mm	Needed when a non-conductive adhesive is used		CR40 EC
Welding rod	5 mm	Acceptable when a conductive adhesive is used		CR50

Important Note: Before installing, refer to Gerflor Installation Handbook for acclimation, job site conditions, subfloor prep, and other general installation recommendations.

1. GENERAL INFORMATION

- 1.1. Gerflor flooring products are formulated to withstand high moisture conditions. To perform as designed, the concrete must be properly prepared to create a contaminant free and porous substrate.
- 1.2. Gerflor flooring products are not designed to withstand hydrostatic or osmotic pressure.
- 1.3. *The guidelines offered within this document are not intended to be all inclusive. Only qualified, professional flooring technicians experienced in the field of resilient flooring should proceed with this installation system.*
- 1.4. It is recommended to mechanically prepare the concrete via grinding or bead blasting the surface to achieve a CSP 1+, clean and porous substrate.
- 1.5. Moisture and pH testing must be performed in accordance with ASTM F710-22.
- 1.6. Adhesive bond tests are recommended to ensure adequate bonding to the substrate.
- 1.7. Do not install material that has visible defects or damage. A contractor that installs material that has visible defects or damage assumes responsibility for that material.

2. COPPER STRIP LAYOUT

- 2.1. Copper strip comes in rolls of 656 linear feet.
- 2.2. The copper strip is 3/8" wide and 0.003" thick.
- 2.3. Layout copper strip and coordinate grounding with a certified electrician.
- 2.4. **Lay one copper strip every three rows of tiles in one direction only.**
- 2.5. **Apply adhesive first and let dry, then lay copper strips on top.**
- 2.6. **The copper must be in contact with the back of the tiles.**

NOTE: THE TILES MUST BE GROUNDED EVERY 400 SQ. FT

Lay copper strips around the perimeter near the walls that connect to create a "box" of copper strip around the room. Coordinate grounding point with an electrician. Leave extra copper at walls for proper grounding.

INSTALLATION INSTRUCTIONS

GTI EL5 CONNECT

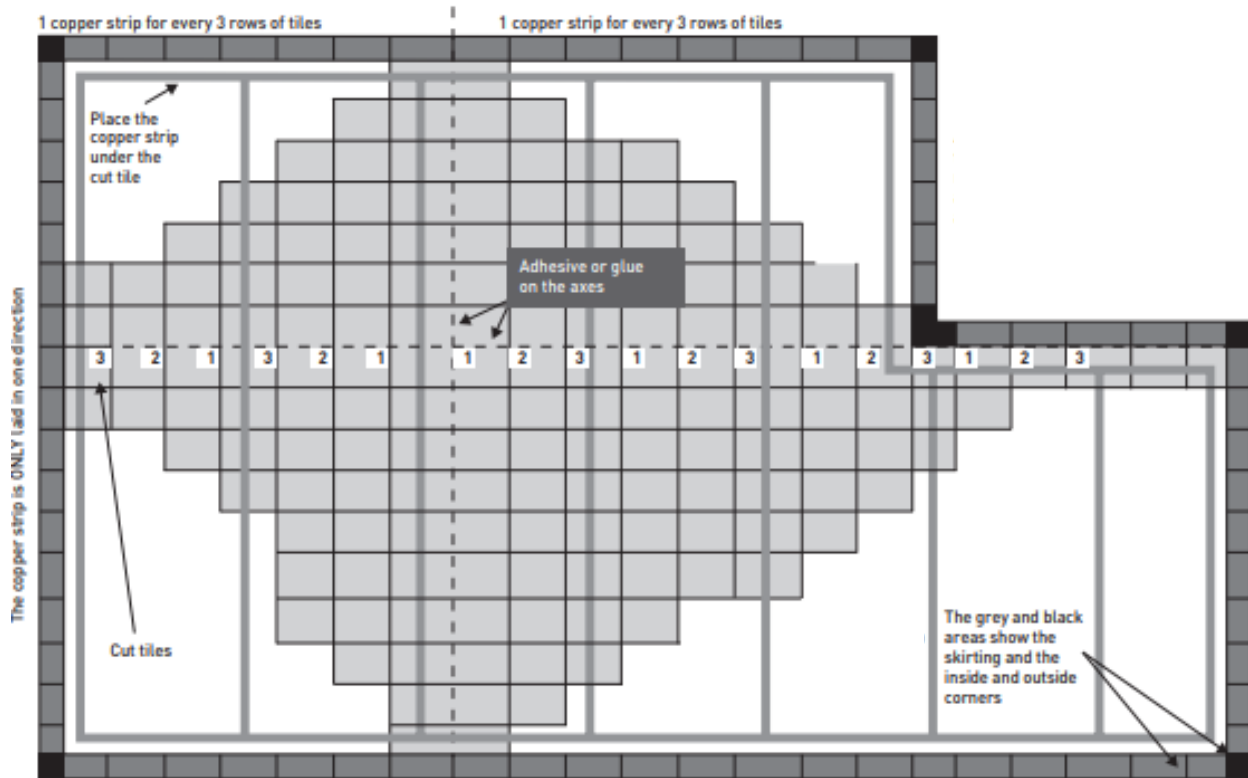

3. LAYOUT AND INSTALLATION

NOTE: When installing GTI EL5 Connect Tiles, **DO NOT** pull tiles tight to each other. Tiles installed too tightly will make the grooving process difficult. Do not leave a gap greater than 1/32-inch-wide between tiles.

- 3.1. Use Gerfix TPS+
- 3.2. **DO NOT** mix batches of tiles.
- 3.3. Chalk the centre lines of the work area in both directions so that one line is parallel to the length of the room and that the second line is on a 90° angle to the first line.
- 3.4. Position centre lines to allow the perimeter tiles to be \geq to $\frac{1}{2}$ tiles.
- 3.5. Before spreading adhesives, it is recommended to lay one or two rows of tiles along both centre lines to check for proper alignment.

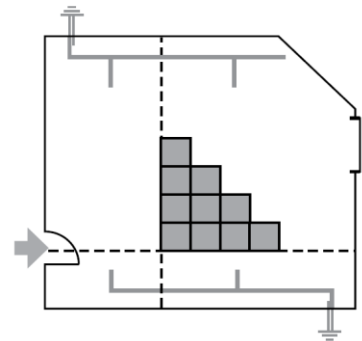

INSTALLATION INSTRUCTIONS

GTI EL5 CONNECT

- 3.6. After the first tile is in place, begin laying tiles outward along both guidelines.
- 3.7. Install tiles in the same direction (see arrows on the back of the tiles.)
- 3.8. Press tiles **lightly** against adjoining tiles and lay them into the adhesive.
- 3.9. Begin stair-stepping the tiles into the field area.

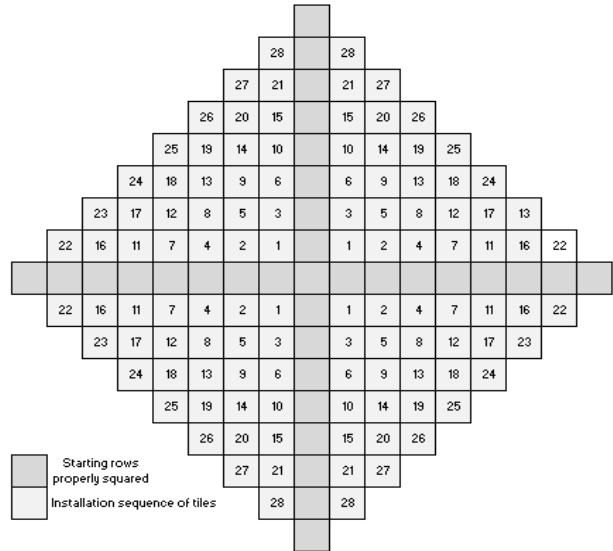

4. SEQUENCE OF TILES

- 4.1. Follow the installation sequence to avoid any failures.

5. CUTTING AND FITTING

- 5.1. For door jambs or other irregular cuts, mark tiles with a pencil, heat with a hot air gun, and cut with a sharp utility blade. The tiles will cut easily when heated sufficiently.
- 5.2. The perimeter cuts can be made with a table saw and fine-tooth blade.
- 5.3. A Bullet PRO I-26 Magnum shears cutter is highly recommended for faster, precise perimeter cutting
- 5.4. A WEN 12 Amp Speed Plunge Cut Circular saw is an economical tool that can also be used for cutting perimeters. (Guide rails are also available.)





INSTALLATION INSTRUCTIONS

GTI EL5 CONNECT

6. INSTALLING USING GERFIX TPS+ ACRYLIC ADHESIVE

NOTE: Conductive weld rod must be used when installing with Gerfix TPS+

- 6.1. Always refer to the **Gerfix TPS+ Adhesive Technical data Sheet**
- 6.2. Recommended trowel size is 1/32" x 1/16" x 1/32", covering from 170 to 220 sq. ft. per US gallon. 
- 6.3. To ensure uniform adhesion of the entire surface, apply a workable amount of adhesive at once.
- 6.4. Maintain a uniform spread rate. Replace trowel (or trowel blade) with every pail used.
- 6.5. Immediately after trowelling the adhesive onto the concrete use a medium-napped paint roller saturated with adhesive to flatten out visible trowel marks and even out the adhesive. **A double arm roller frame is recommended to ensure an even coat of adhesive.**
- 6.6. "Open time" of the adhesive is dependent upon porosity of the substrate, temperature, and humidity. It is important that the installers familiarize themselves with the adhesive before starting the installations.

<i>Application Characteristics over Porous Substrates (Non-Porous-see note below)</i>		
	<i>Open Time*</i>	<i>Working Time**</i>
Gerflor GTI EL 5 Connect Tiles	20 to 40 minutes (to reach a tacky state***)	Up to 1.5 hours

* **Open Time:** is the wait time required before installing flooring into the adhesive.

** **Working time:** is the wait time required before installing flooring into the adhesive.

*** **Tacky:** When adhesive starts to become translucent and there is light transfer to the fingers when slightly touched resulting in transfer to the backing of the flooring.

Note: For Non-Porous substrates let the adhesive dry completely, with no transfer to the fingers when touched, then immediately install the flooring and roll with a 100 lb. roller.

- 6.7. Starting from the centre line and working outward, apply the adhesive and install tiles when the adhesive is ready.
- 6.8. Press tiles lightly against adjoining tiles and press into the adhesive.
- 6.9. Periodically, lift the edge of a tile to confirm transfer of adhesive to the back of the flooring. There must be adhesive transfer for the tiles to be adequately secured to the substrate.
- 6.10. Once flooring is placed into the adhesive, immediately roll thoroughly with a 3 section 100 lbs roller in both directions.
- 6.11. Always roll seams, at the walls, and under toe kicks with a hand roller to ensure 100% transfer of adhesive.
- 6.12. During the installation, with the lights on and off, always double-check the flooring for bubbles with portable, ambient, and/or fixed lighting.
- 6.13. **Avoid adhesive displacement by prohibiting traffic for a period of 24 hours and 72 hours for rolling loads.**

INSTALLATION INSTRUCTIONS

GTI EL5 CONNECT

7. FLASHCOVING SHEET VINYL WITH GTI CONNECT

- 7.1. Measure and cut GTI tiles 4 inches from all perimeter walls.
- 7.2. If SPM wall panels are to be installed, the wall panels should be installed first and then the flooring. Eliminate the cove cap and underscribe the vinyl to the wall panels to ensure evenly spaced seams for welding.

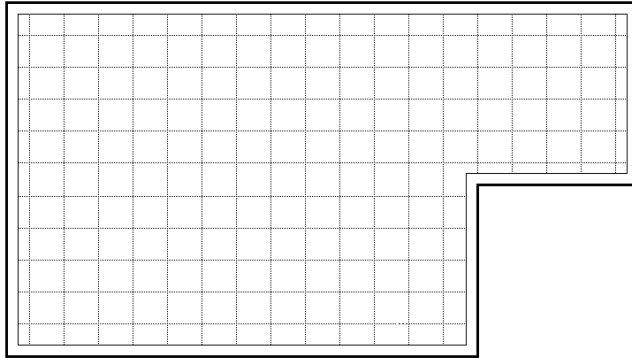

- 7.3. On the 4" edge of the perimeter, install Gerflor 4 mm GTI Underlayment and then install the cove stick on top of it. (Use same adhesive as used to install the flooring.)
- 7.4. Measure height for cap metal and install.
- 7.5. Metal cap is preferred over vinyl.
- 7.6. Cut the homogeneous sheet to the desired size to complete the flashcoving.

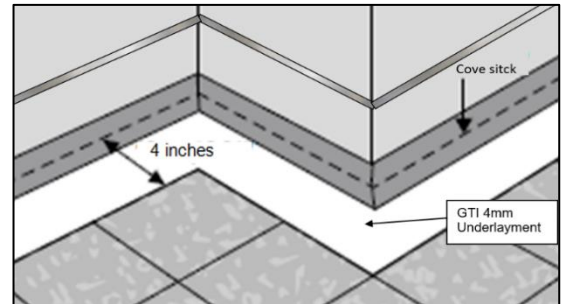

- 7.7. Apply adhesive and install the pieces of homogeneous sheets to the floor and wall, being careful to ensure it is tight in the cove stick.
- 7.8. Mitre the inside and outside corner seams and cut the vinyl net with the walls vertically on the corners. This flashcoving method is sometimes called picture framing, or border coving.
- 7.9. Roll floor, cove radius, and walls with hand roller to ensure proper bonding.
- 7.10. Weld all vertical and corner seams and trim with hand tools.

8. CLEAN CORNER INSTALLATION – REFER TO THE “CLEAN CORNER” DOCUMENT

- 8.1. When installing the Clean Corner system, and to achieve the inside and outside corners, a minimum of 12" pieces of vinyl will need to be cut and used to fill in each corner.
- 8.2. Fit pieces in the corner by butting up squarely to the GTI tiles. Heat with hot air guns, fold back and install per the Clean Corner Installation Document.

INSTALLATION INSTRUCTIONS

GTI EL5 CONNECT

- 8.3. After fitting the inside and outside corner pieces, measure distance of walls between each corner and install the appropriate size pieces of sheet vinyl. Make clean vertical seams between the inside and outside corner pieces.

9. DOORWAYS AND TERMINATIONS

9.1. ALUMINUM PROFILE

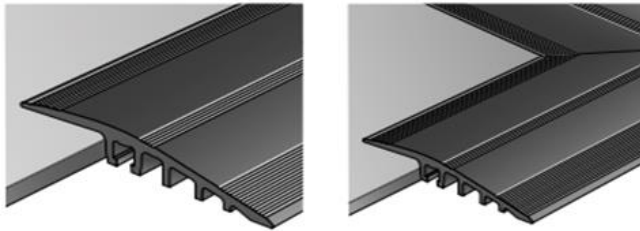

- 9.2. For heavy traffic. (Pre-made corner pieces are also available.)
9.3. 4 mm x 50 mm and 30 mm long nylon plugs are included in profile kit.
9.4. Cut tiles and lay metal at desire location.
9.5. Hold metal securely and use hammer to drill 3 mm pilot holes through the centre of each hole.
9.6. Remove metal and finish holes with 6 mm drill bit.
9.7. Vacuum holes and insert nylon plugs
9.8. Realign metal and secure with 4 mm x 50 mm screws and Philipps screwdriver.

9.9. GTI ACCESS AND CORNER PIECES

- 9.10. For moderate traffic, only available for GTI
9.11. Must be glued down using T-111 adhesive
9.12. Weight down until adhesive cures

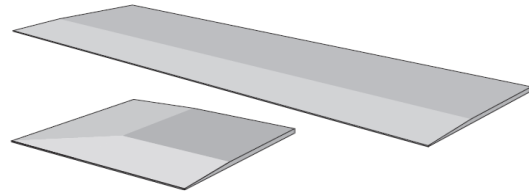

10. HEAT WELDING - REFER TO THE “HEAT WELDING GERFLOR VINYL PRODUCTS” DOCUMENT

11. ONCE THE INSTALLATION IS COMPLETED

- 11.1. Perform a visual inspection of the project.
11.2. Verify every welded seam.
11.3. Repair every imperfection before leaving the project.
11.4. Make sure that every vertical obstacle such as doorframes is well trimmed and sealed with an acrylic, silicone, or equivalent sealant product.
11.5. To maximize the aesthetic appearance and serviceability of the newly installed flooring, provide your customer with a copy of the **Gerflor Maintenance Instructions**.